

# Installation Manual

SKODA OCTAVIA ESTATE  
SKO-OCTA-E-D



## Shades



Side Shades



Port Shades



Tailgate Shades

## Fixing Clips



CL-M12 x 2



CL-M02 x 2



CL-M14 x 1



CL-M09 x 4



CL-T01 x 1

# Installation

SKODA OCTAVIA ESTATE  
SKO-OCTA-E-D

## Components Needed



Side Shades



CL-M09 x 4



CL-T01 x 1

## Side Shade Installation

### STEP 1



### STEP 2



### STEP 3



### STEP 4



### STEP 5



### STEP 6



Repeat steps 3 & 4 for the other M09 clip

# Installation

SKODA OCTAVIA ESTATE  
SKO-OCTA-E-D

## Side Shade Installation

### STEP 7

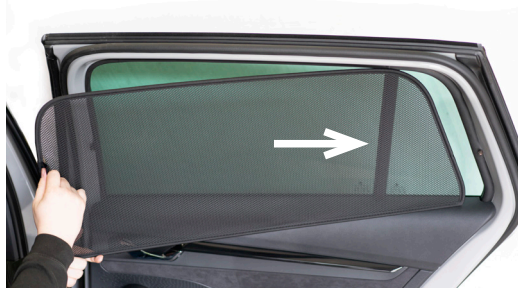

### STEP 8

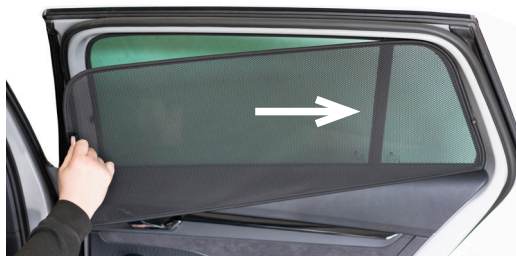

### STEP 9



### STEP 10



### STEP 11



*Repeat this whole process for the other side*

# Installation

SKODA OCTAVIA ESTATE  
SKO-OCTA-E-D

## Components Needed



Port Shades



CL-M02 x 2

## Port Shade Installation

### STEP 1

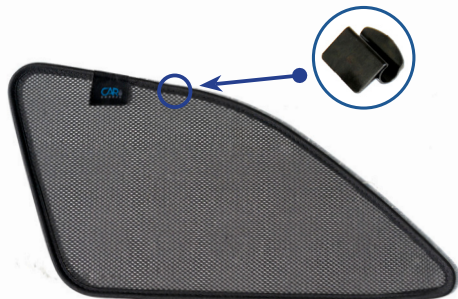

### STEP 2



### STEP 3



### STEP 4

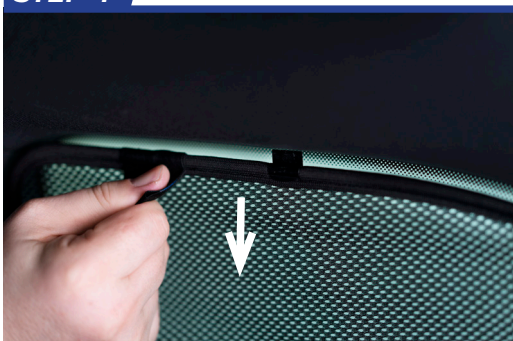

### STEP 5

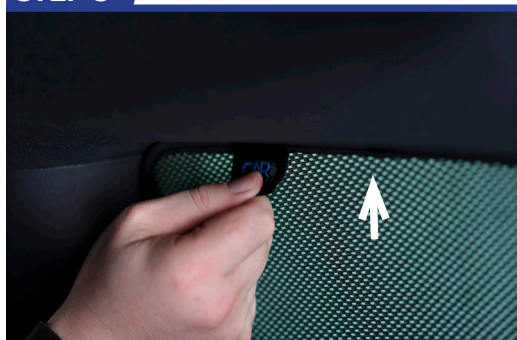

### STEP 6



Repeat this whole process for the other side.

# Installation

SKODA OCTAVIA ESTATE  
SKO-OCTA-E-D

## Components Needed



Tailgate Shades



CL-M12 x 2



CL-M14 x 1

## Tailgate Shade Installation

### STEP 1

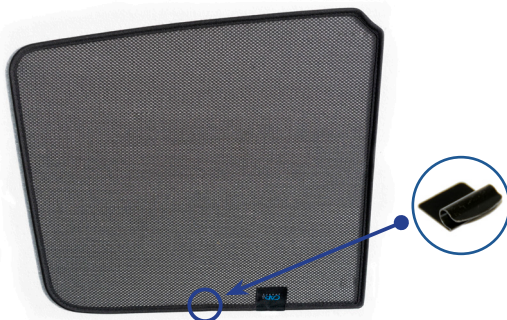

### STEP 2



### STEP 3

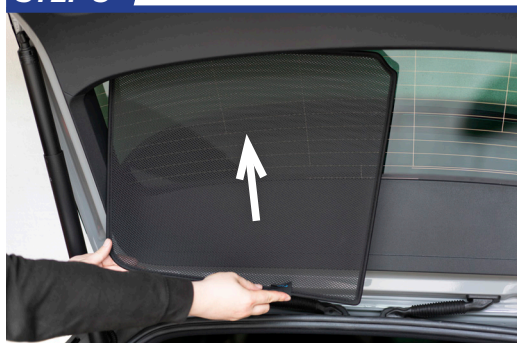

### STEP 4

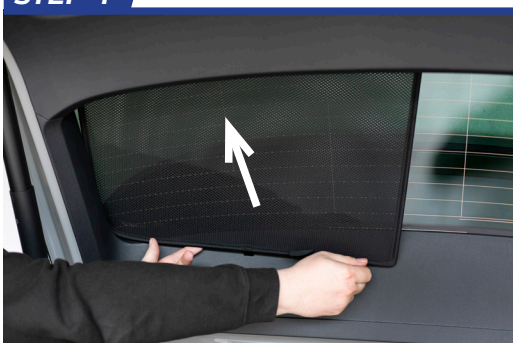

### STEP 5



### STEP 6

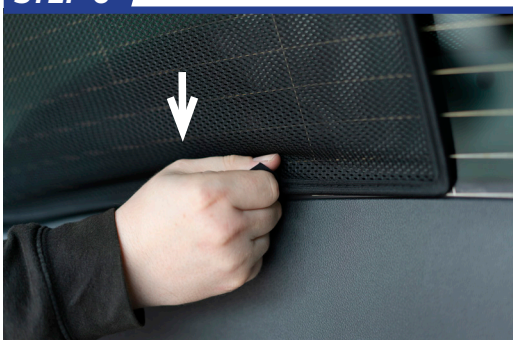

# Installation

SKODA OCTAVIA ESTATE  
SKO-OCTA-E-D

## Tailgate Shade Installation

### STEP 7



Repeat this whole process for the other side

### STEP 8

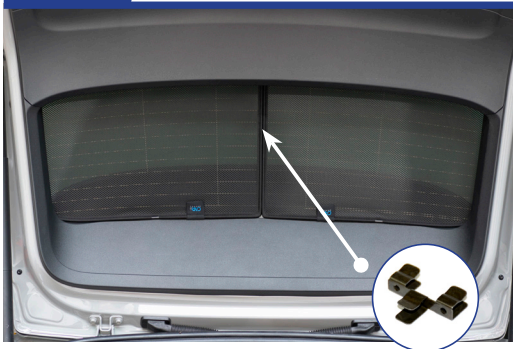

### STEP 9



### STEP 10

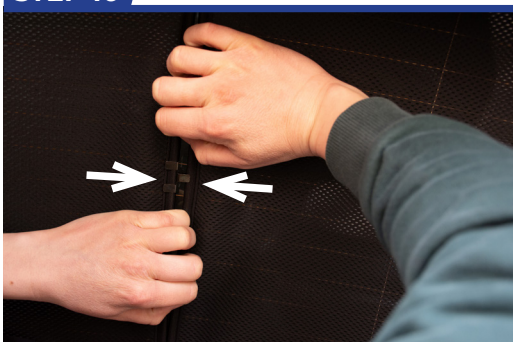

### STEP 11

